

microSHIFT

SWORD Rear Derailleur Cage Swap

† SWORD

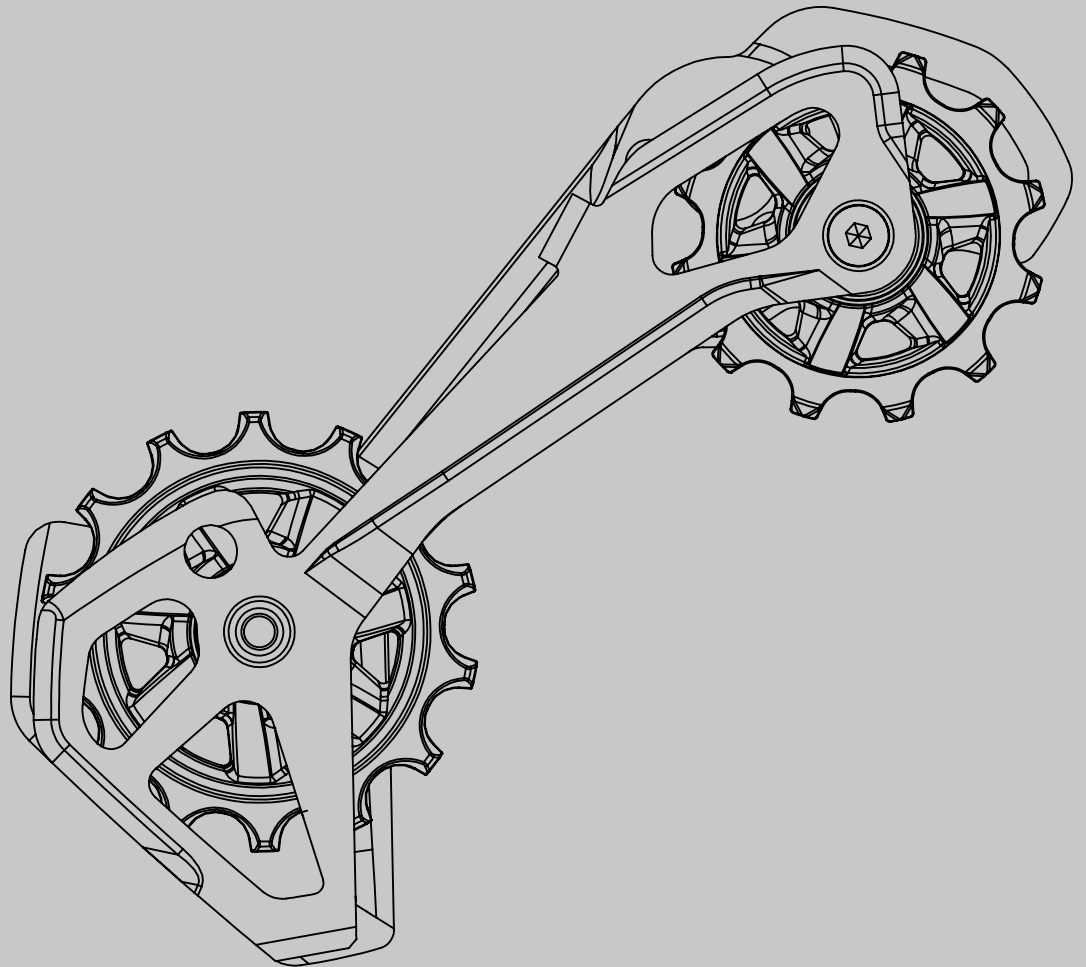

Important Notice



REMINDER

Before installing the products, please read and understand the installation procedures. Improper installation can lead to premature product failures or even injuries. If you have any questions on how to install, please contact us or consult with a professional bicycle mechanic.

Tools and Supplies

Part I

1. 2mm Hex Wrench
2. 3mm Hex Wrench
3. 4mm Hex Wrench
4. 5mm Hex Wrench
5. Blue Loctite 242



1.

Turn the **clutch** off by turning the switch counterclockwise.

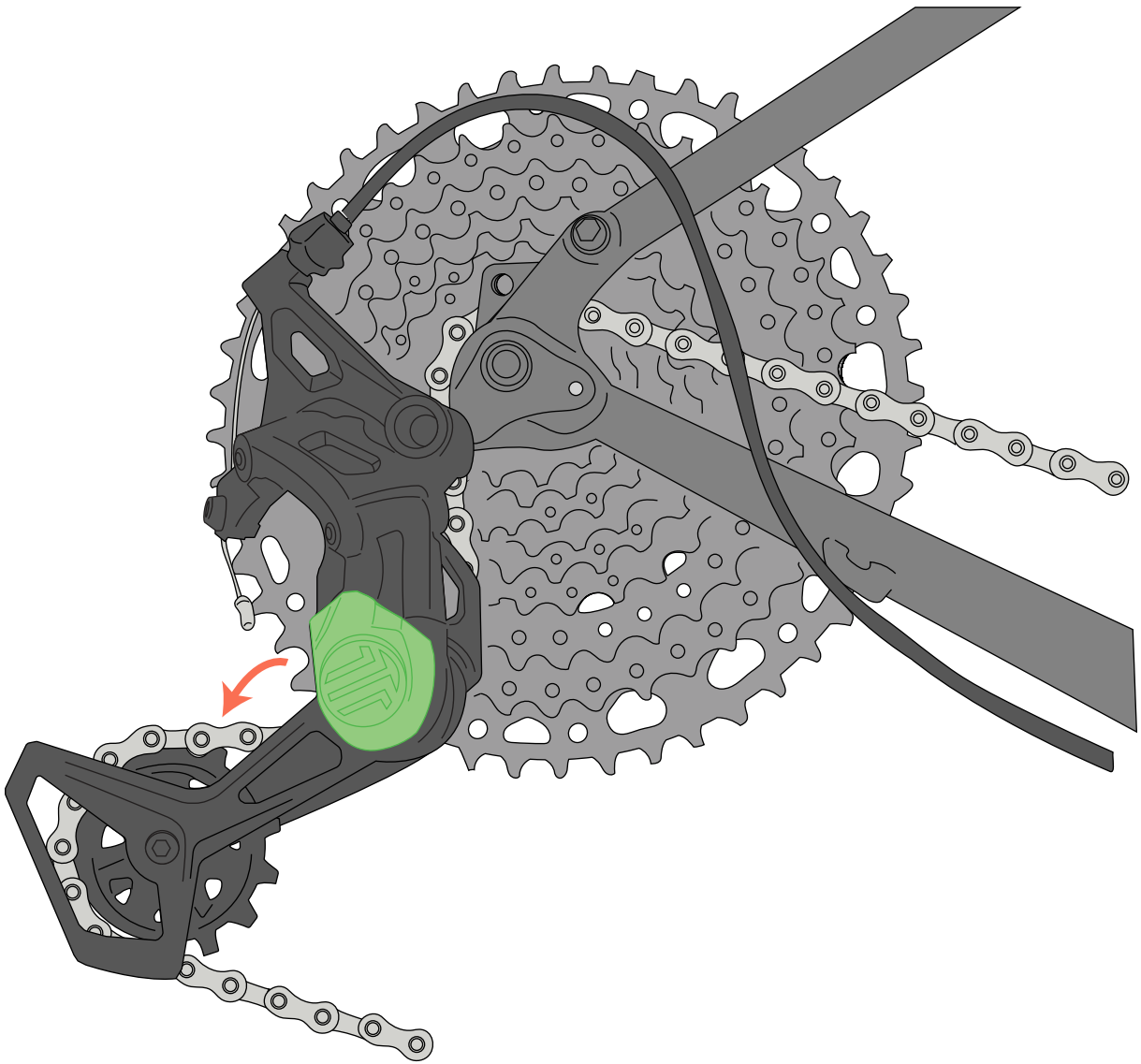

2.

Derailleur Removal

Disconnect **the chain** according to the chain manufacturers guidelines and thread it through the derailleur.

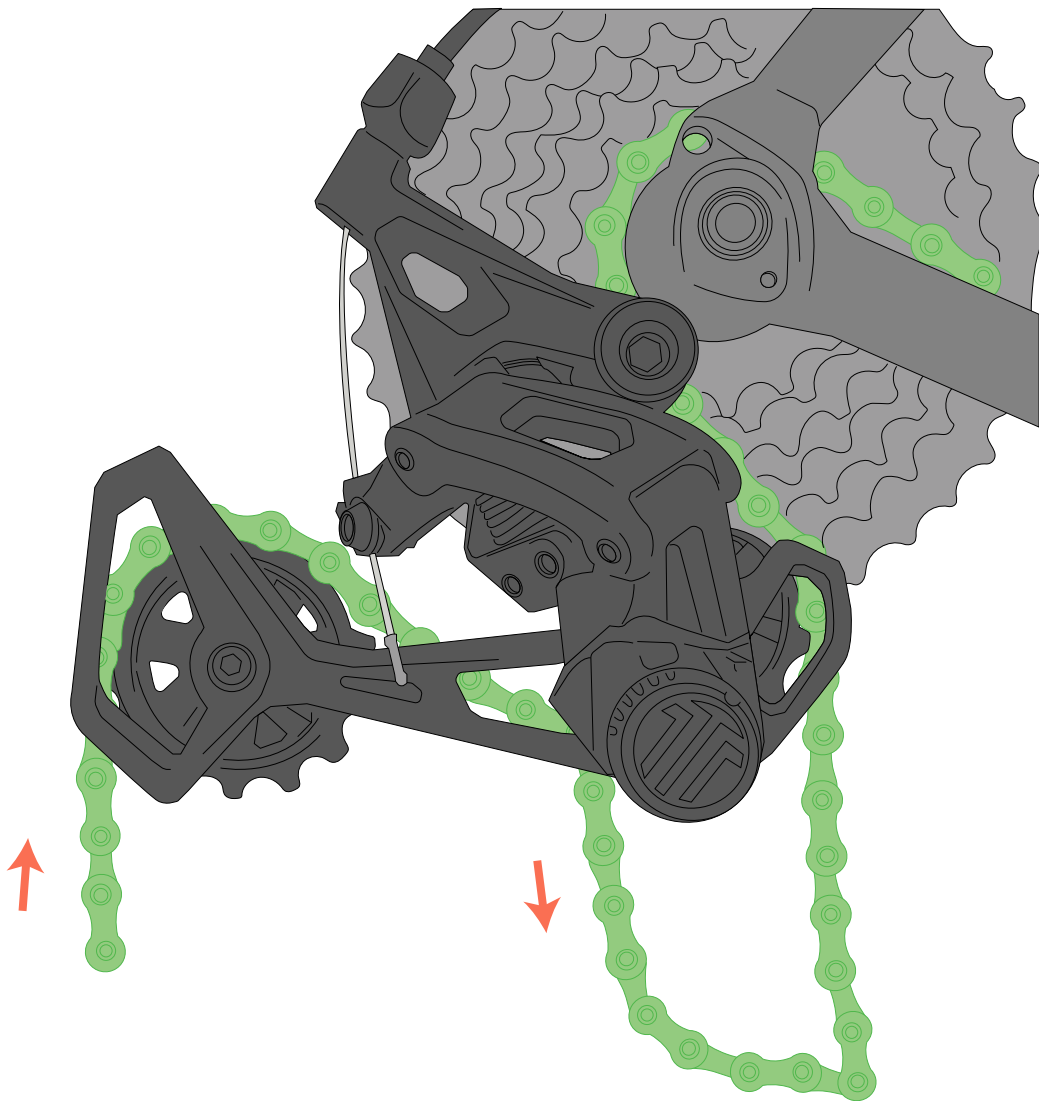

3.

Derailleur Removal

Loosen the **cable fixing bolt** with a **4mm hex wrench** and disconnect the shift cable.

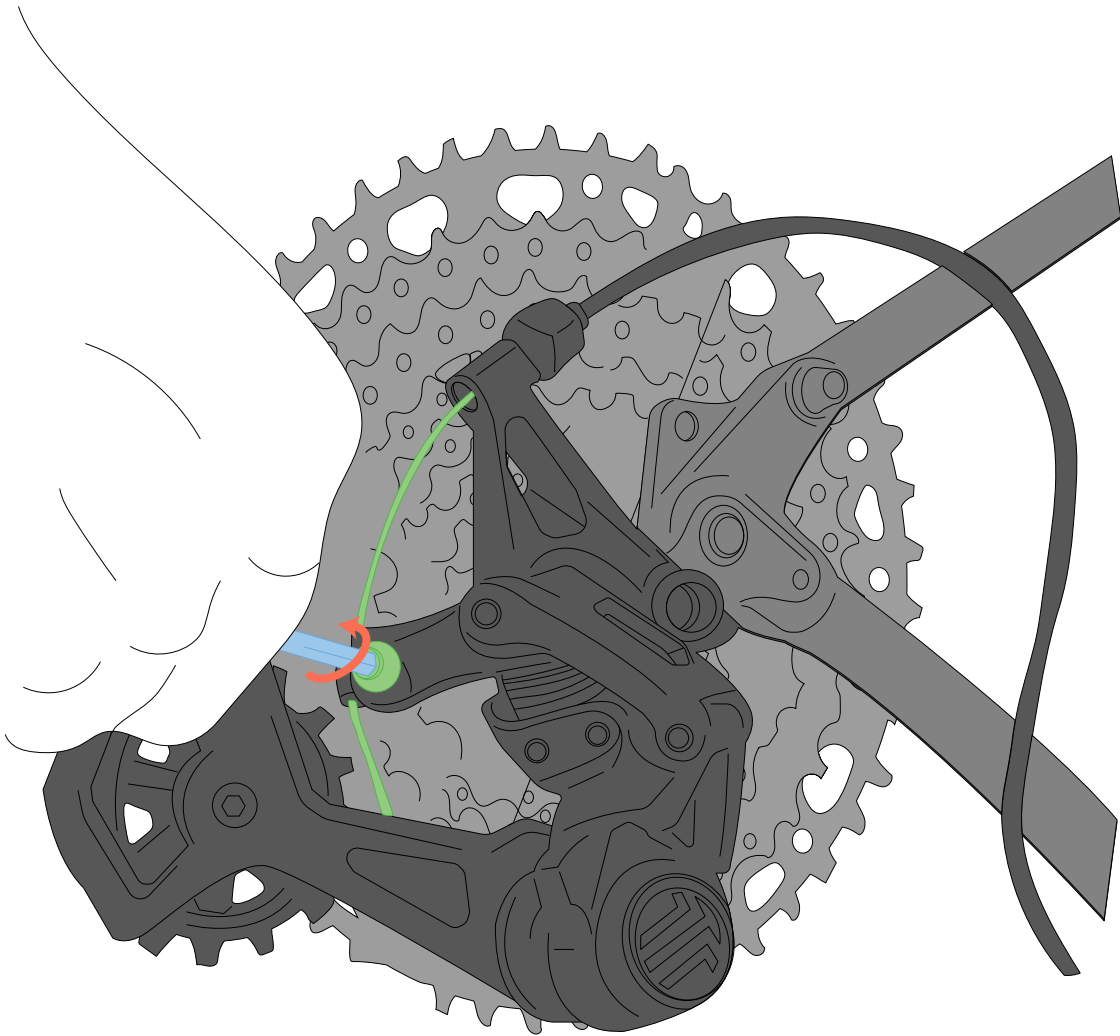

4.

Derailleur Removal

Unthread the **derailleur attachment bolt** with a **5mm hex** wrench and remove the derailleur from the bike.

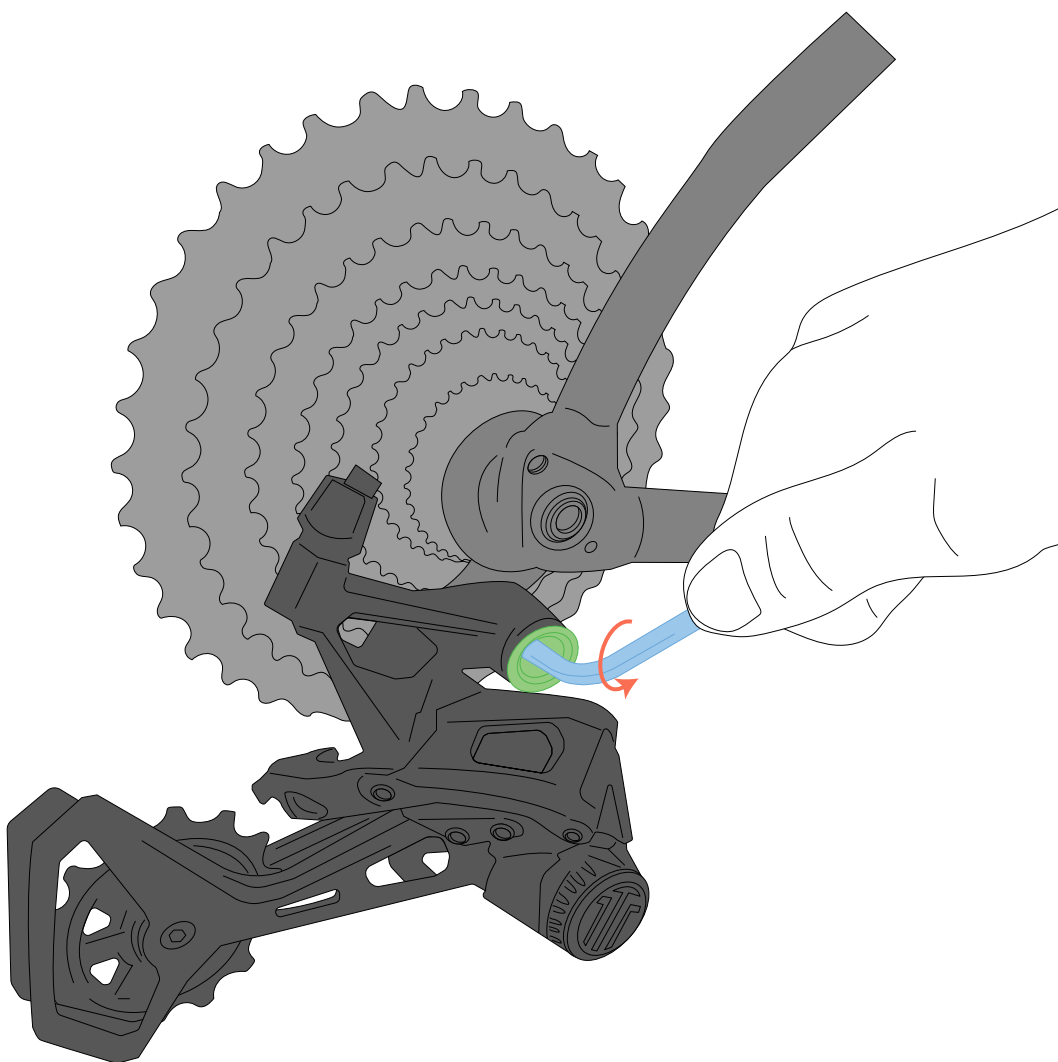

1.

Cage Removal

Unthread and remove the **guide pulley mounting bolt** with a **3mm hex wrench**.

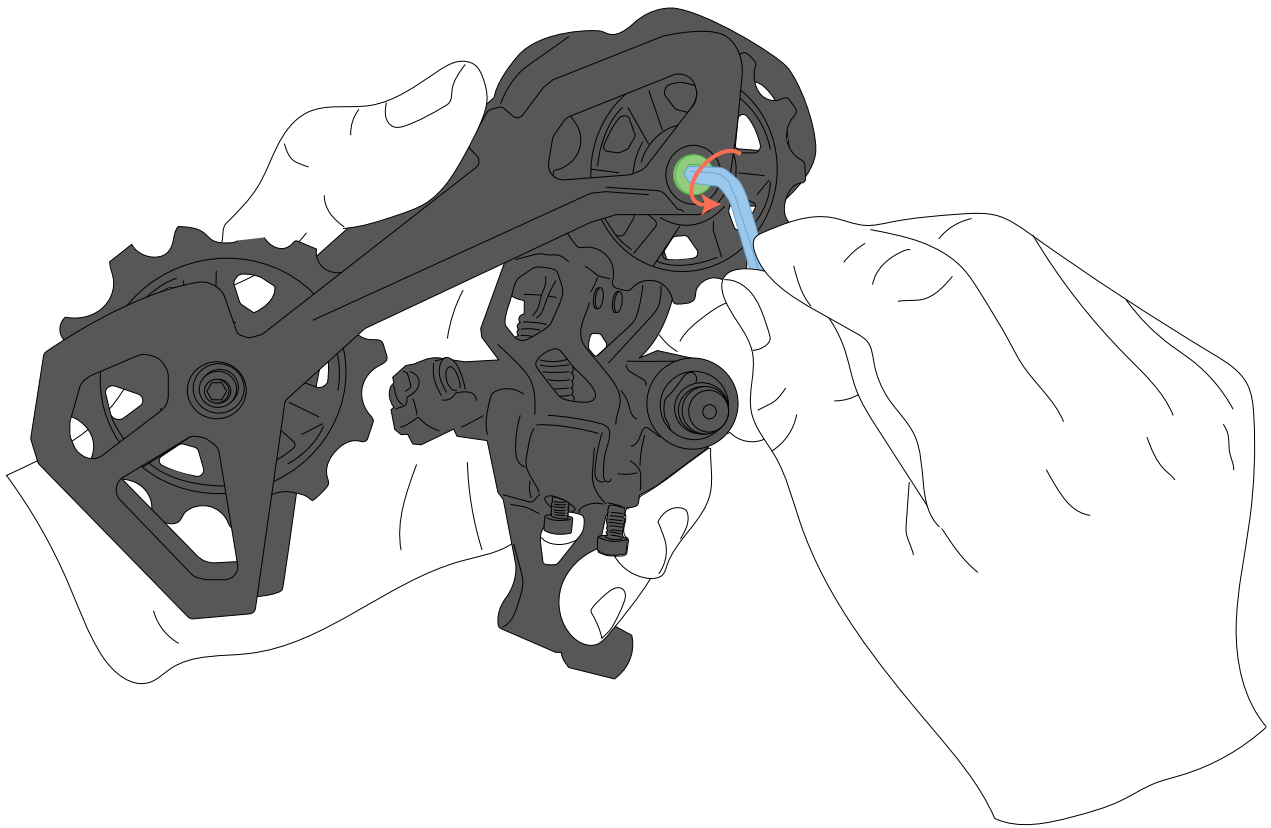

2.

Remove the **guide pulley**. There is an **outer plate** on each side of the **guide pulley**. Hold them in place as you remove the **guide pulley**.

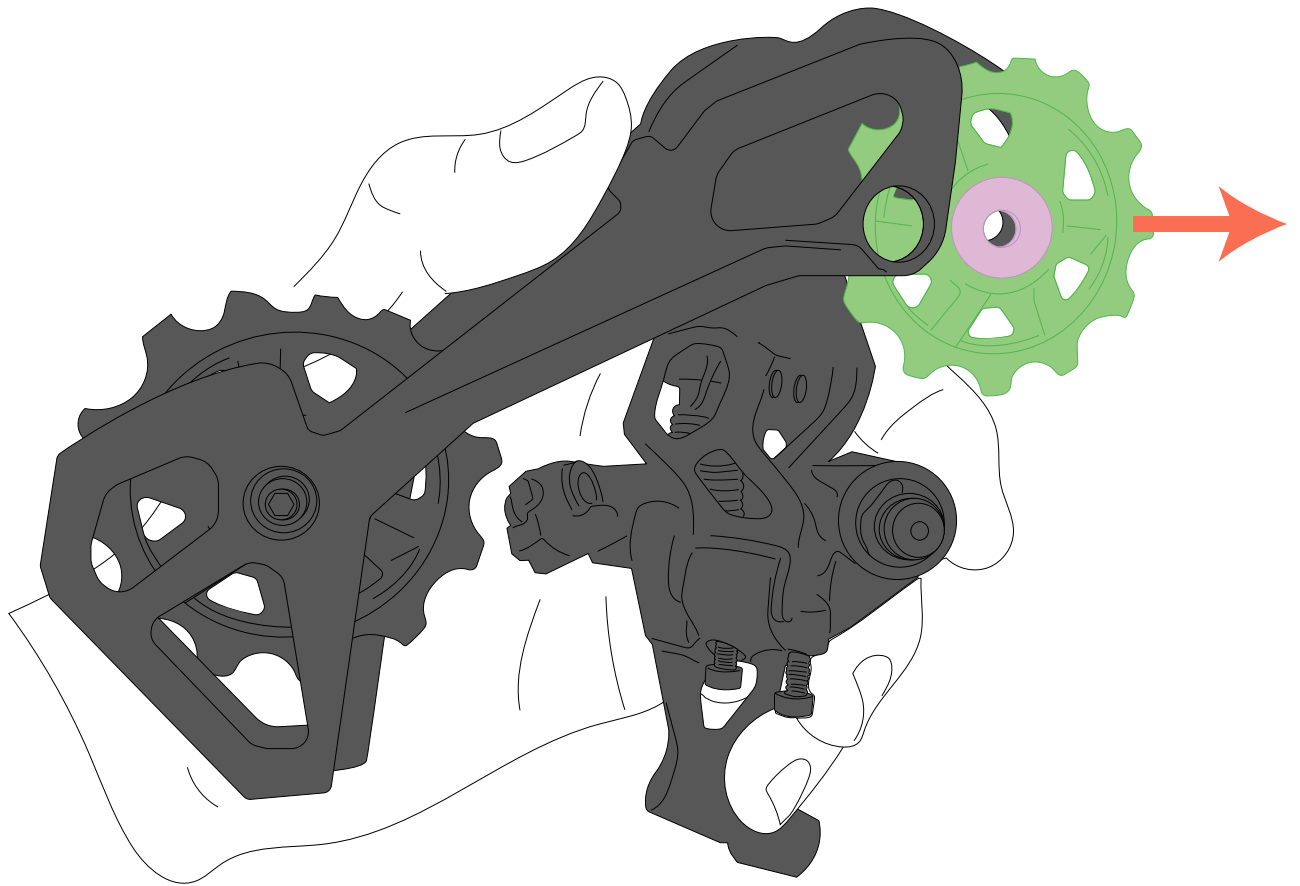

3.

Rotate **the outer plate** of the derailleur cage to access the **cage attachment bolts**.

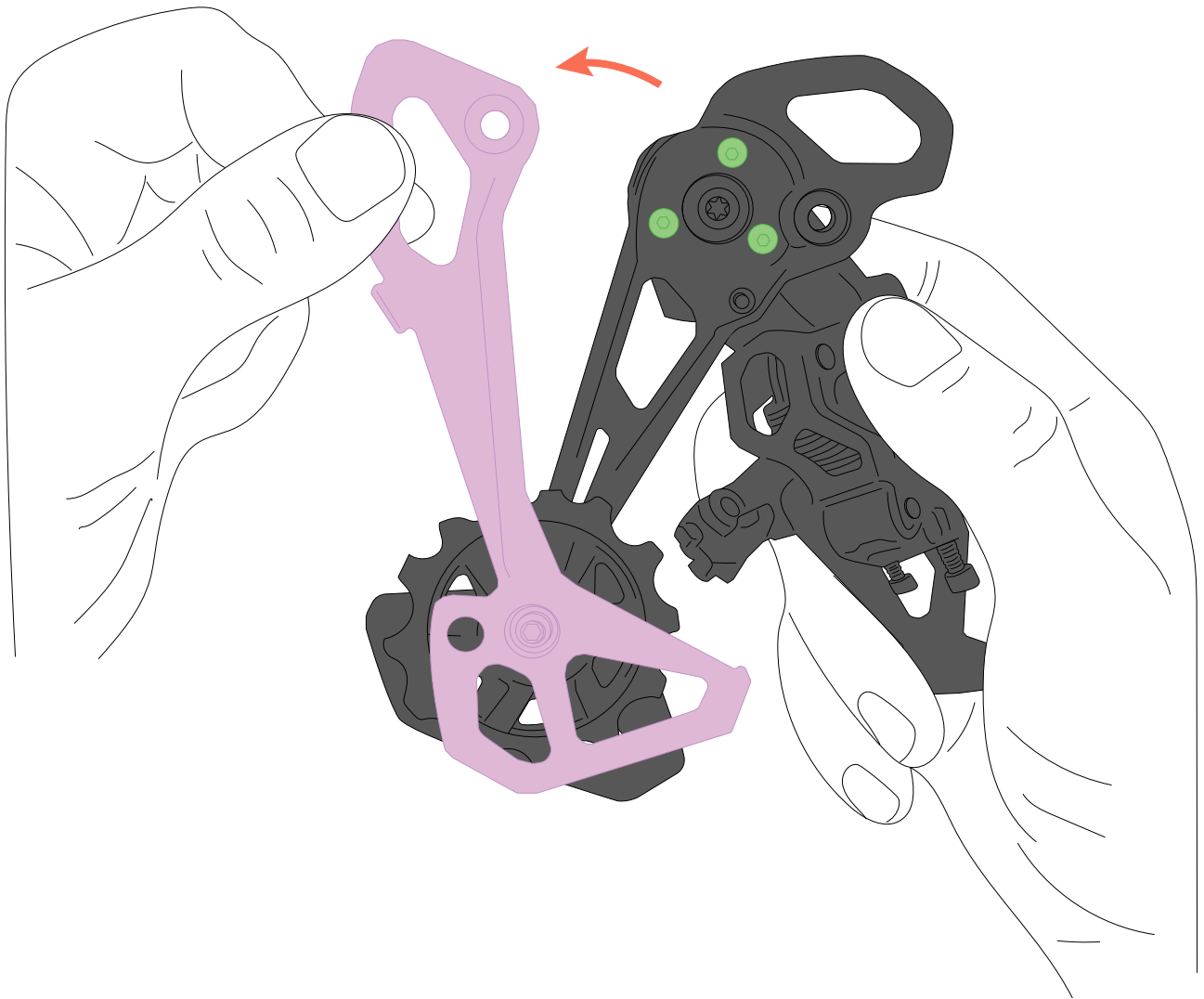

4.

Cage Removal

Unthread and remove the **three cage attachment bolts** with a **2mm hex wrench**.

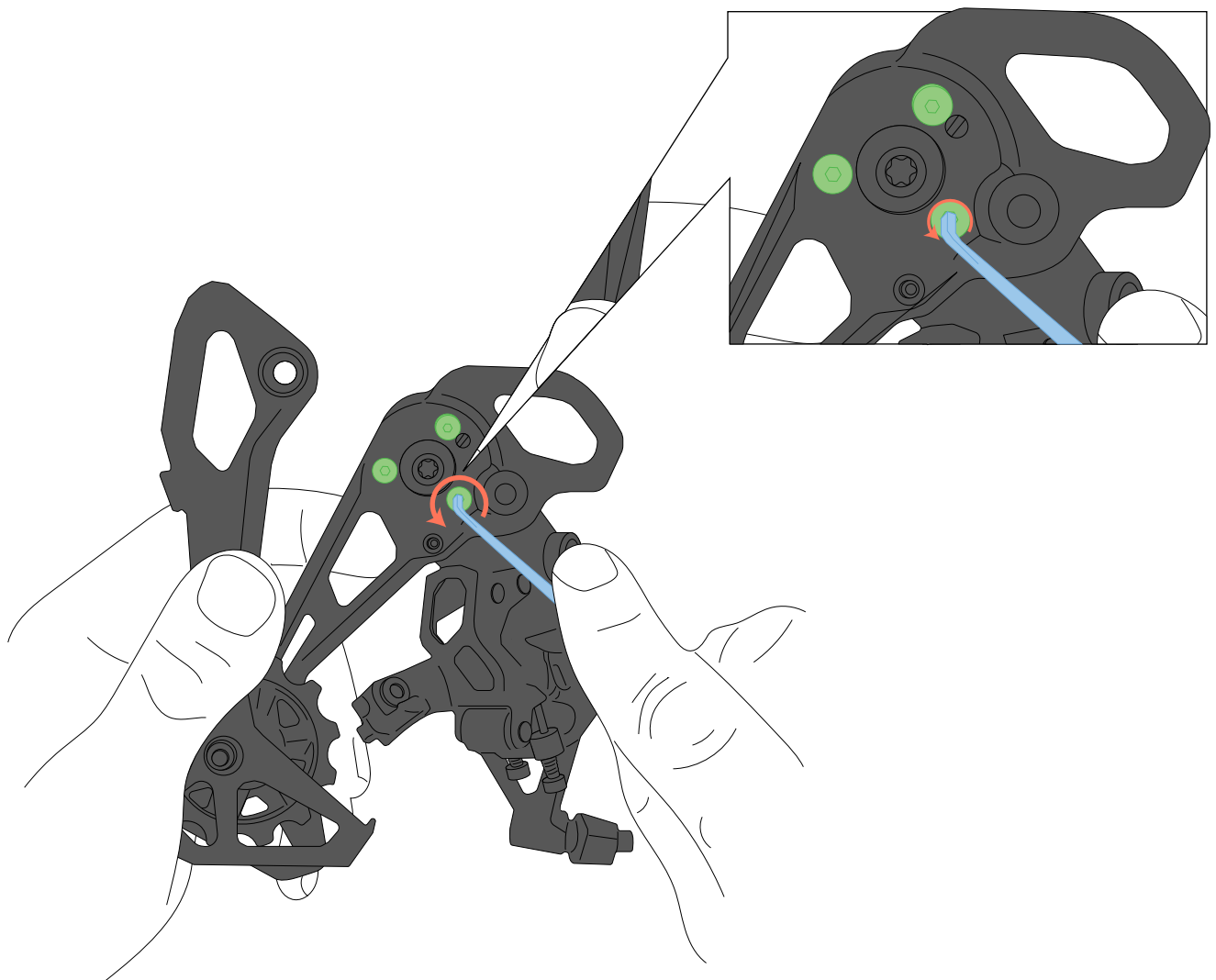

5.

Remove the **derailleur cage** from the **derailleur body**.

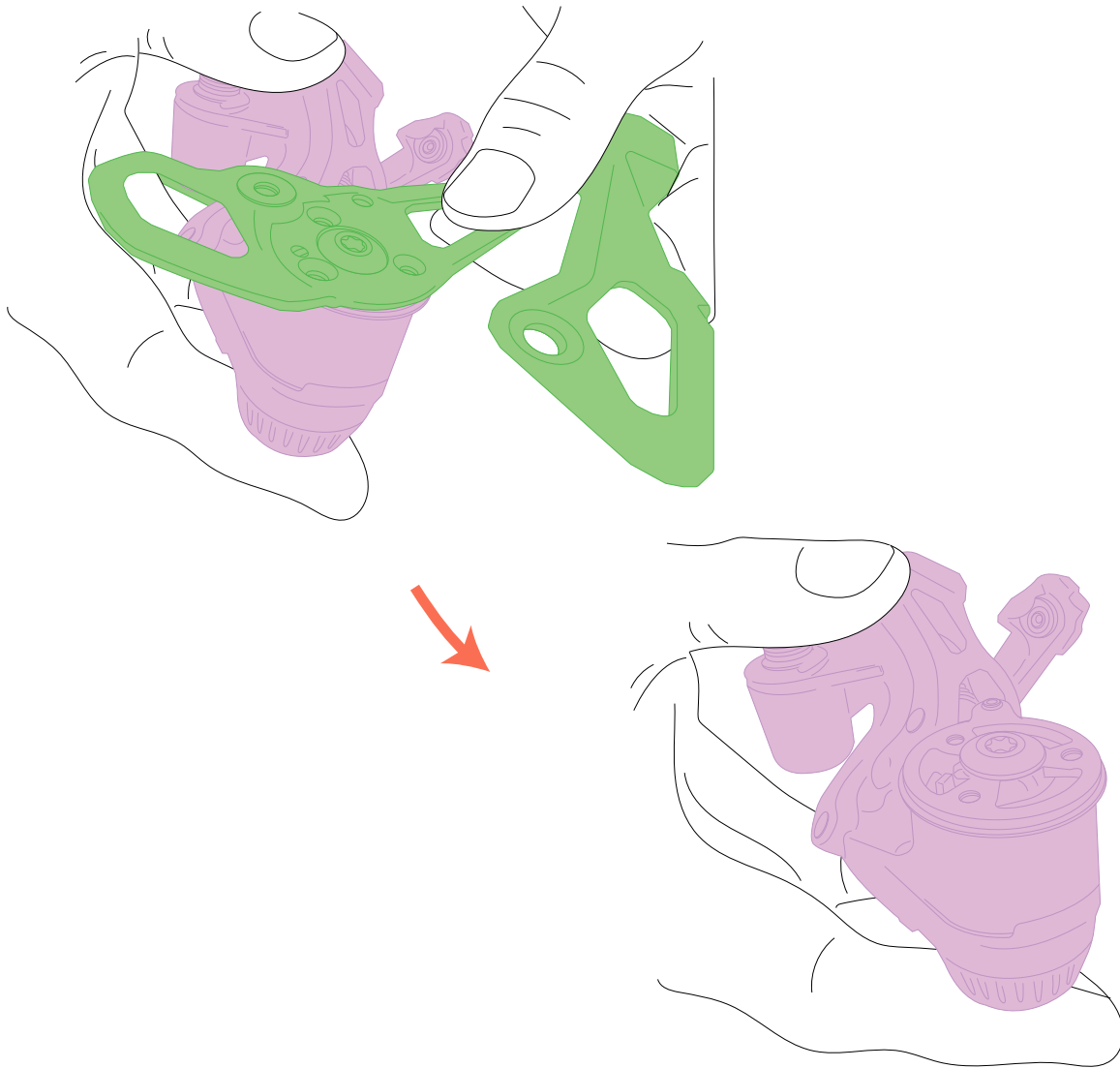

1.

Cage Installation

Remove the **guide pulley mounting bolt** from the replacement cage using a **3mm hex wrench**. The guide pulley sits opposite the **stamped circle** found next to the tension pulley.

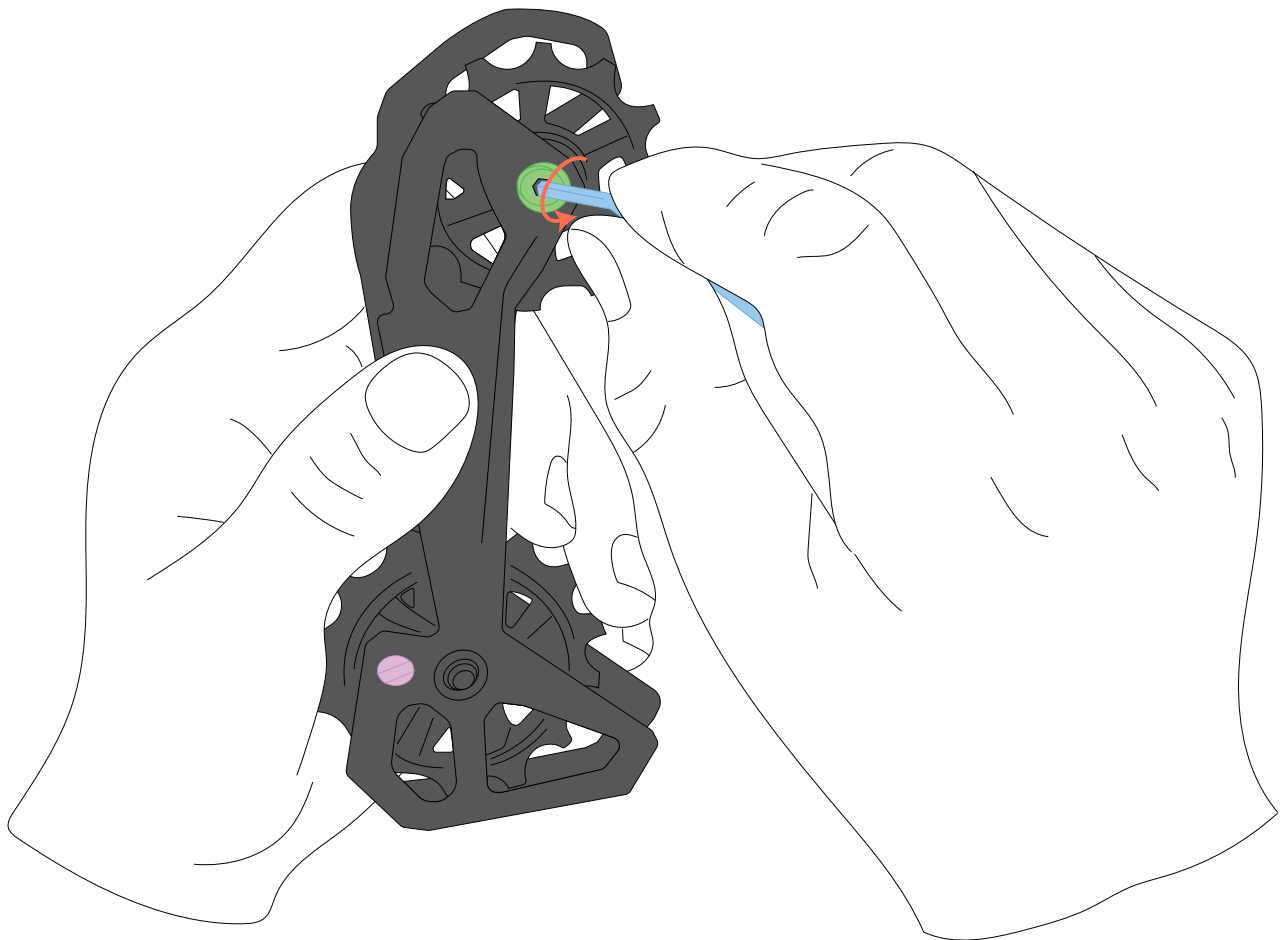

2.

Remove the **guide pulley**.



3.

Rotate the **outer cage** to access the derailleur cage **mounting points**.

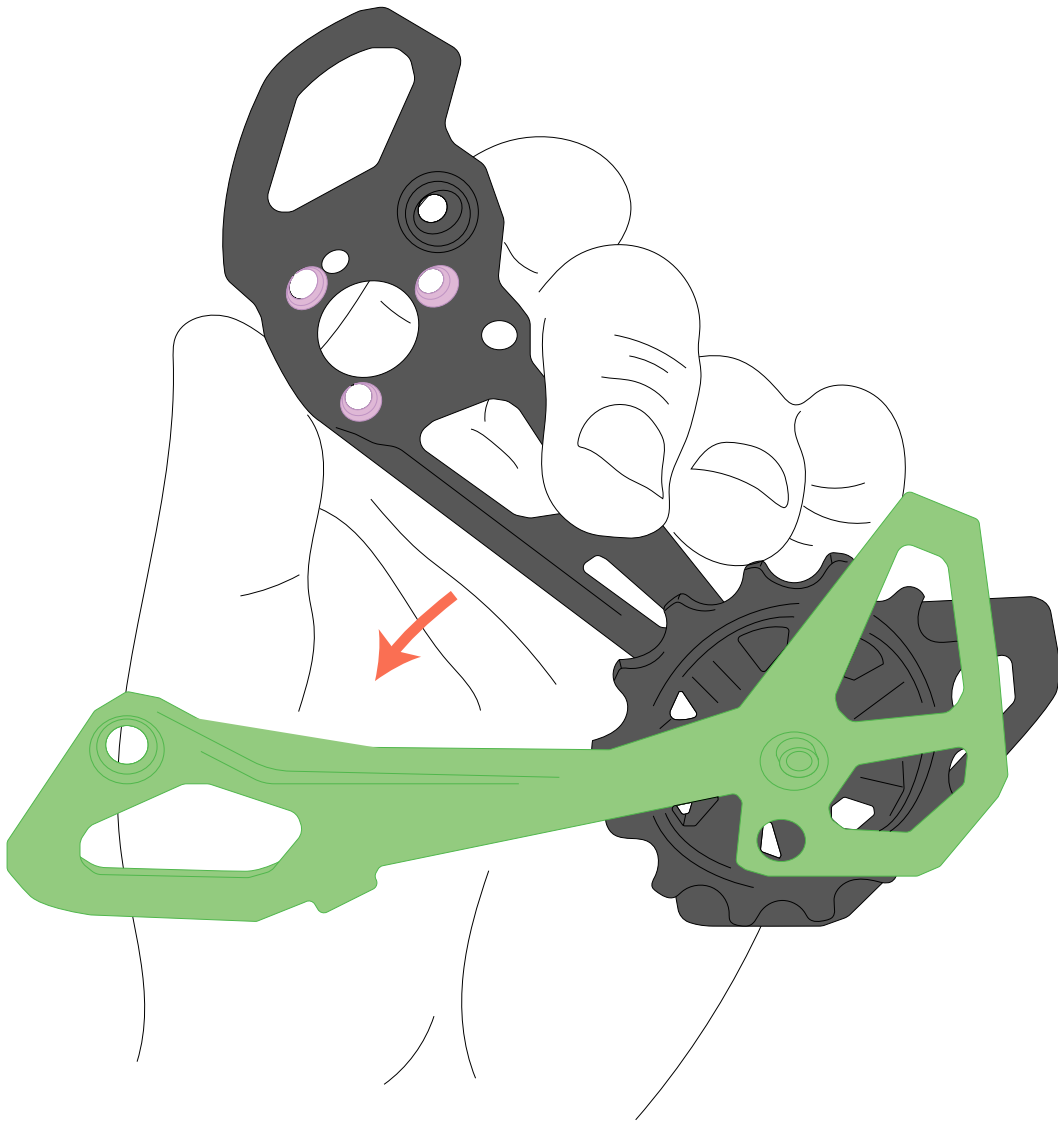

4.

Align the **mounting points of the cage** with the **mounting points on the derailleur body**.

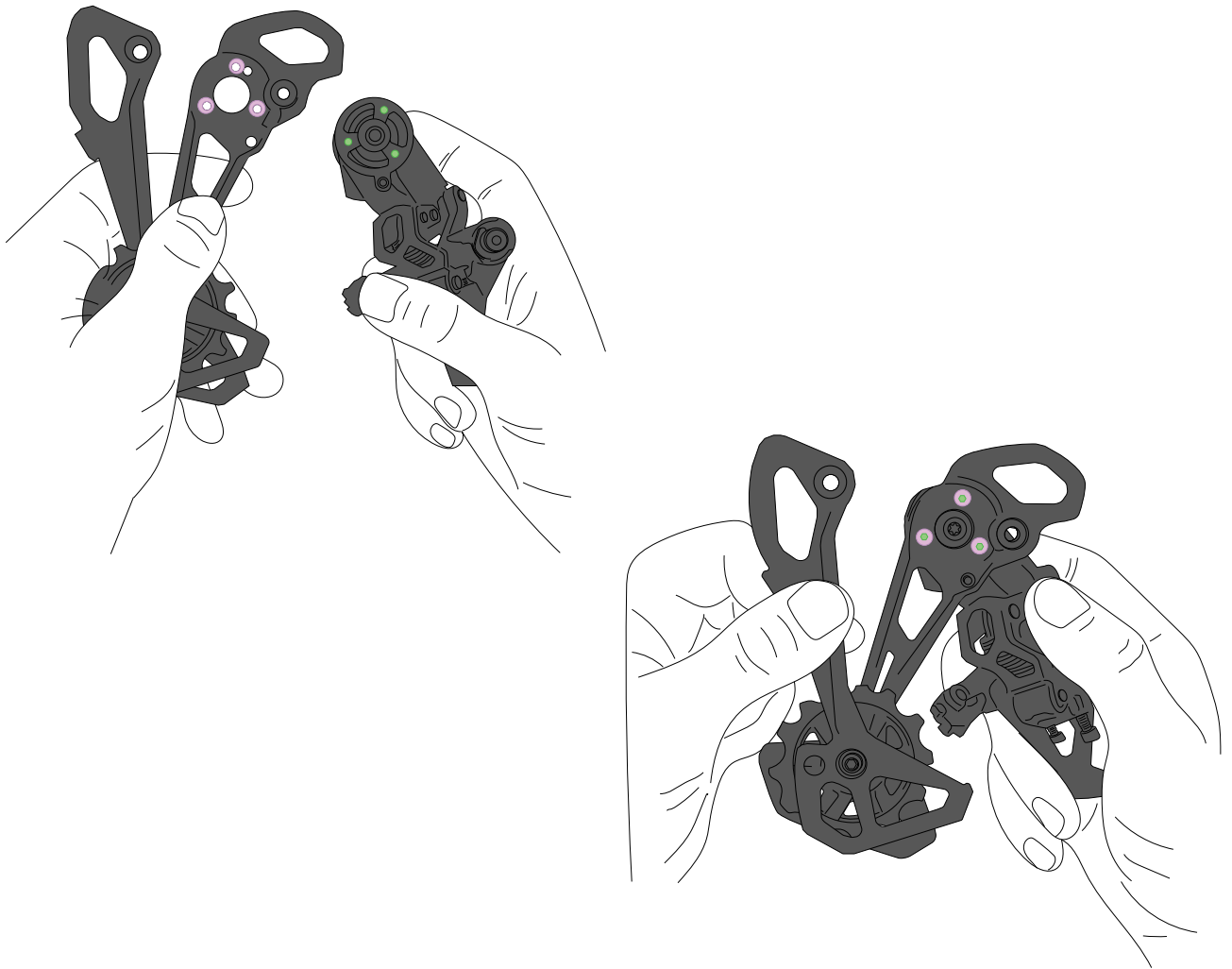

5.

Make sure the **return spring tab** and **stop screw** line up with the matching holes on the **cage**.

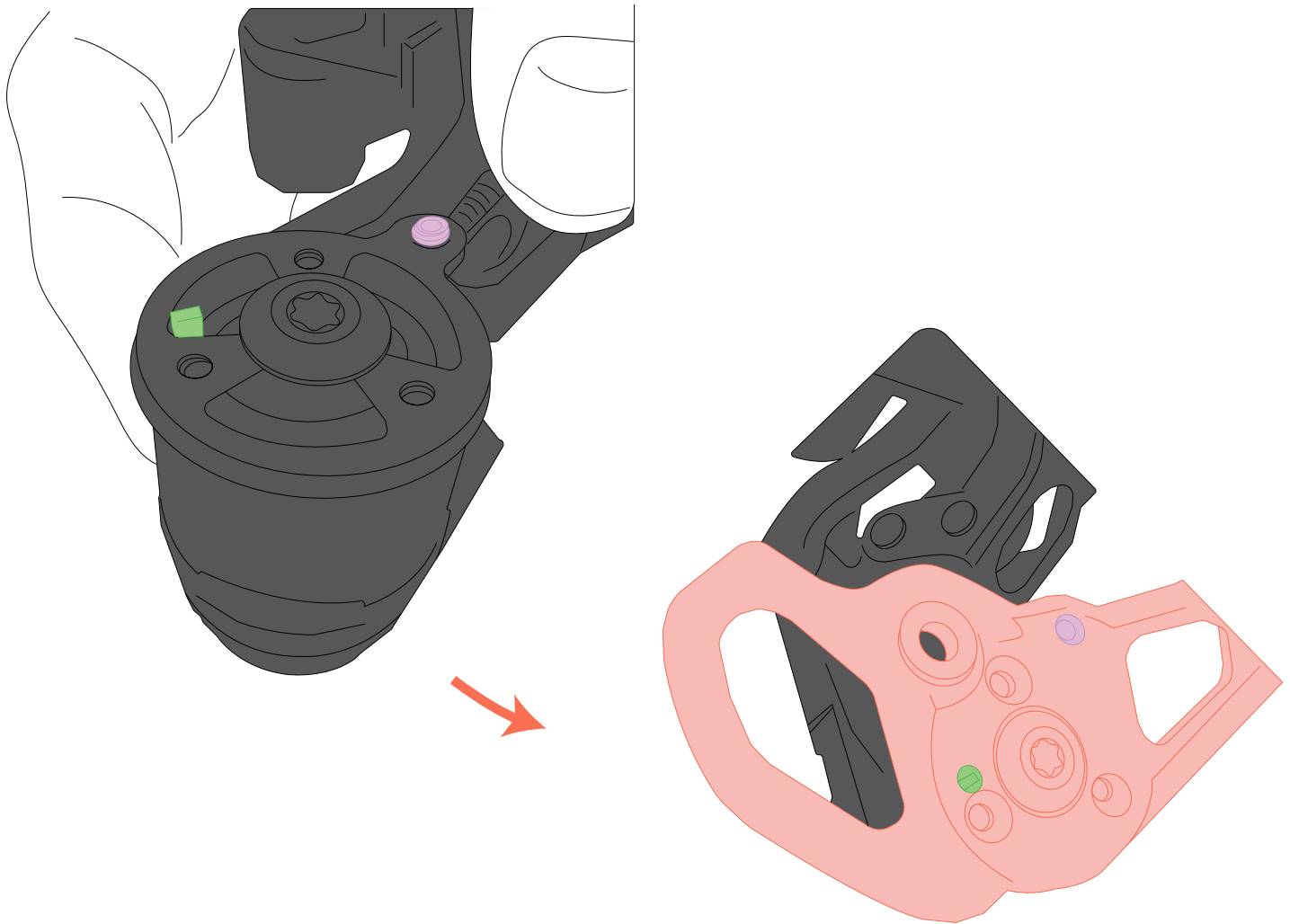

6.

Apply blue Loctite to the **3 cage attachment bolts** and thread them into the mounting points. Torque to **1Nm**.

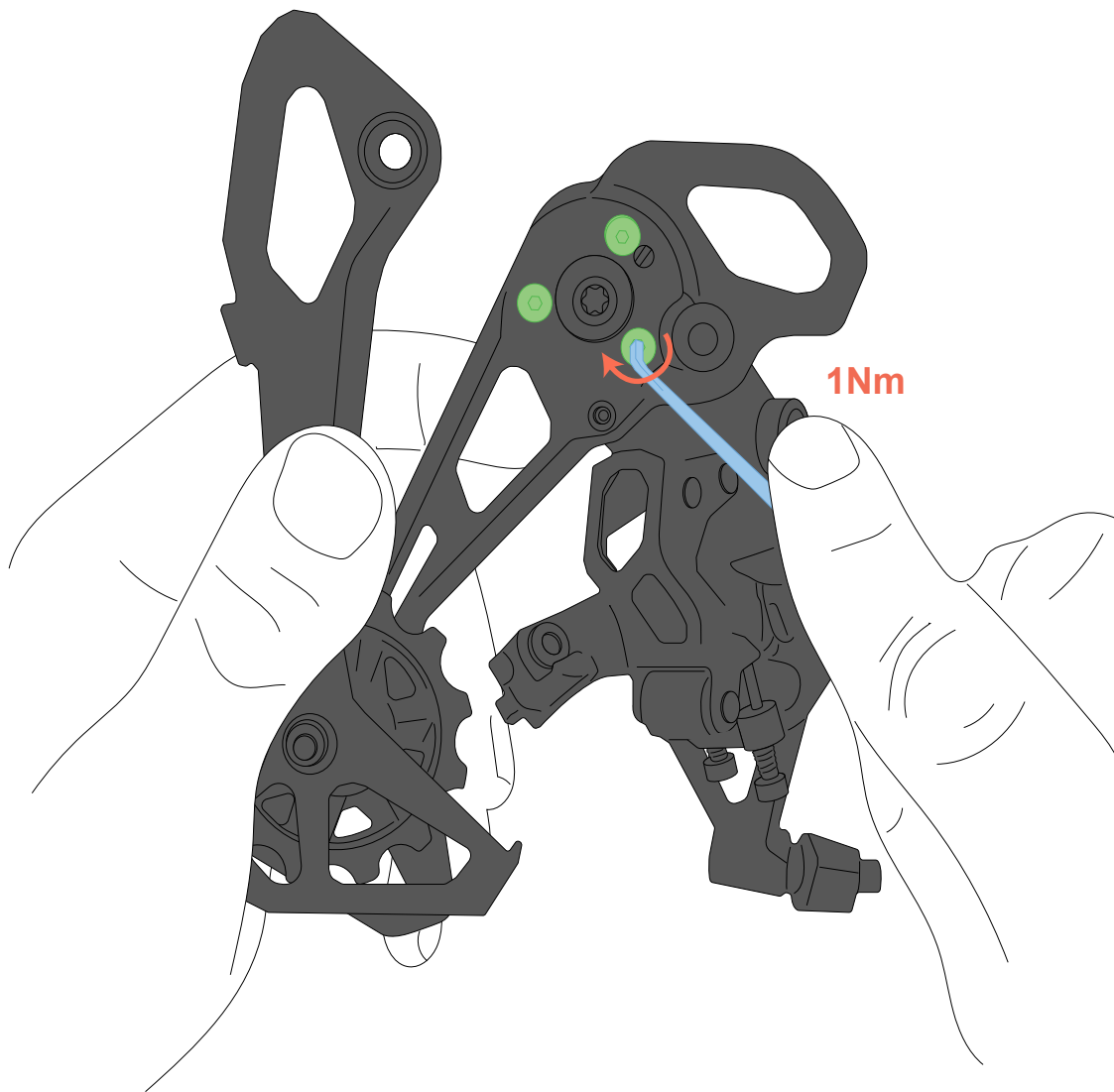

7.

Insert the **bushing** into **the center of the guide pulley**.

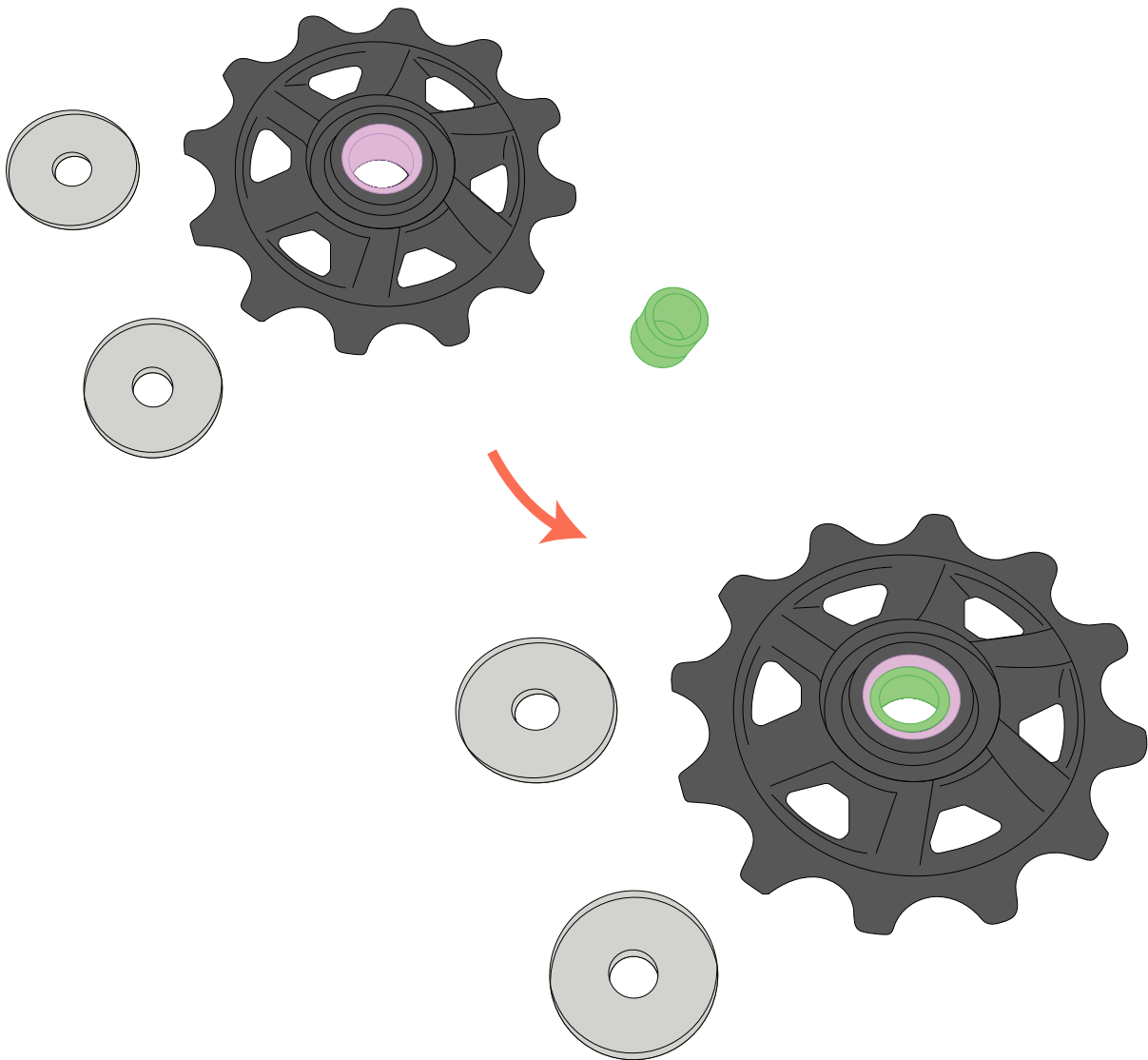

8.

Install an **outer plate** on both sides of the guide pulley. Make sure the raised edge of the outer plate sits in the groove on the guide pulley.

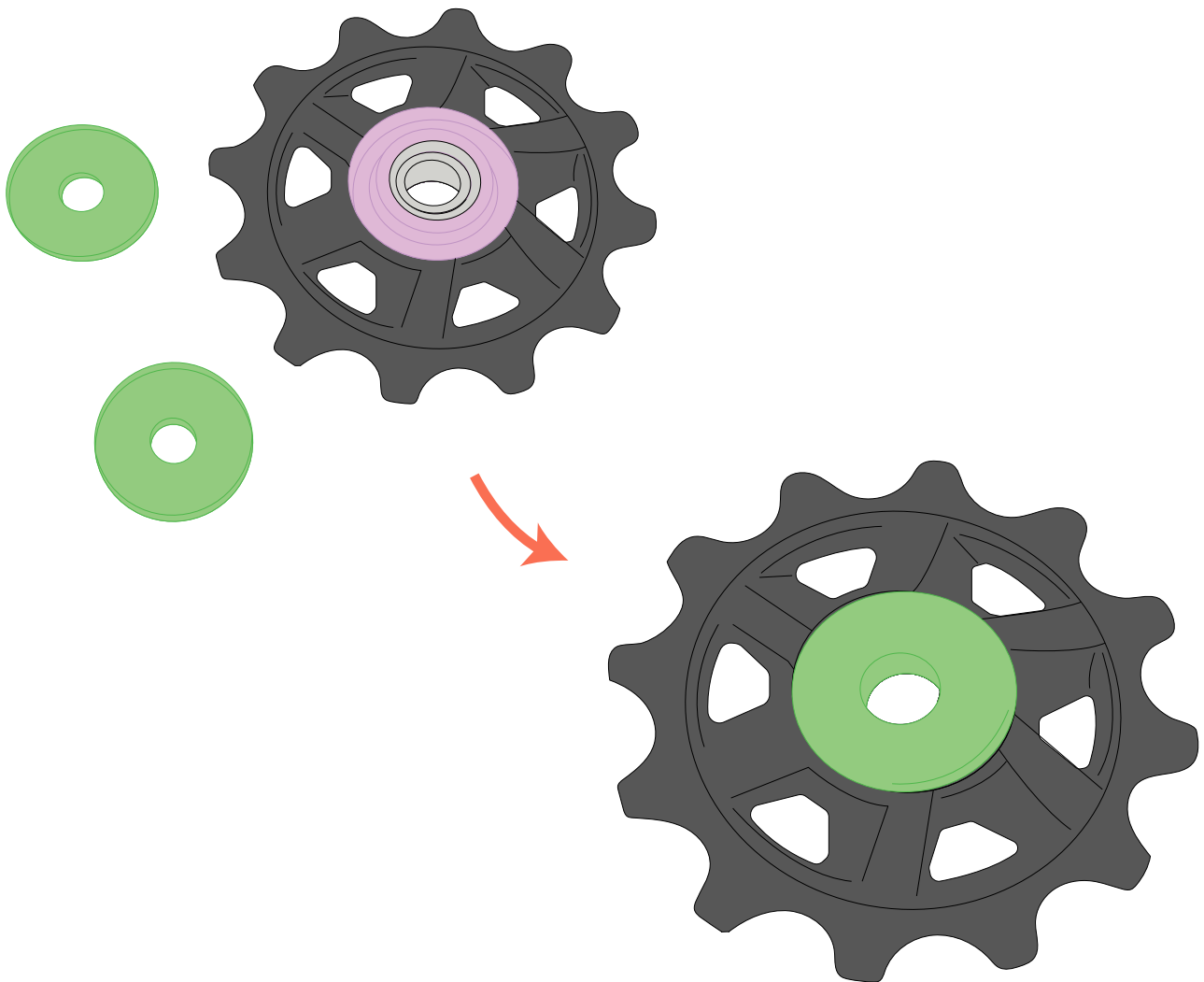

9.

Rotate **the outer plate** of the derailleur cage into position.

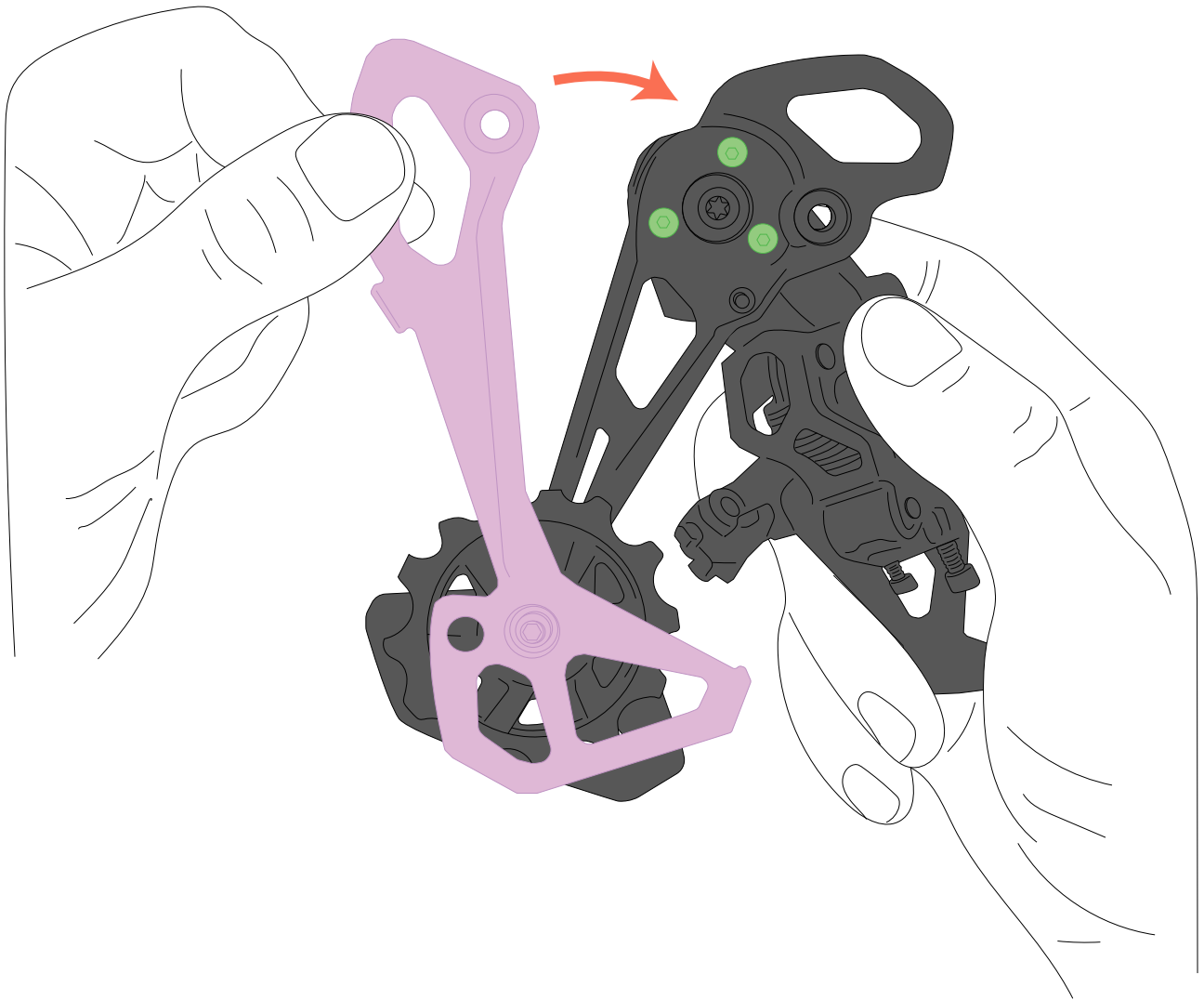

10.

Slide the **guide pulley** and **outer plates** into place.

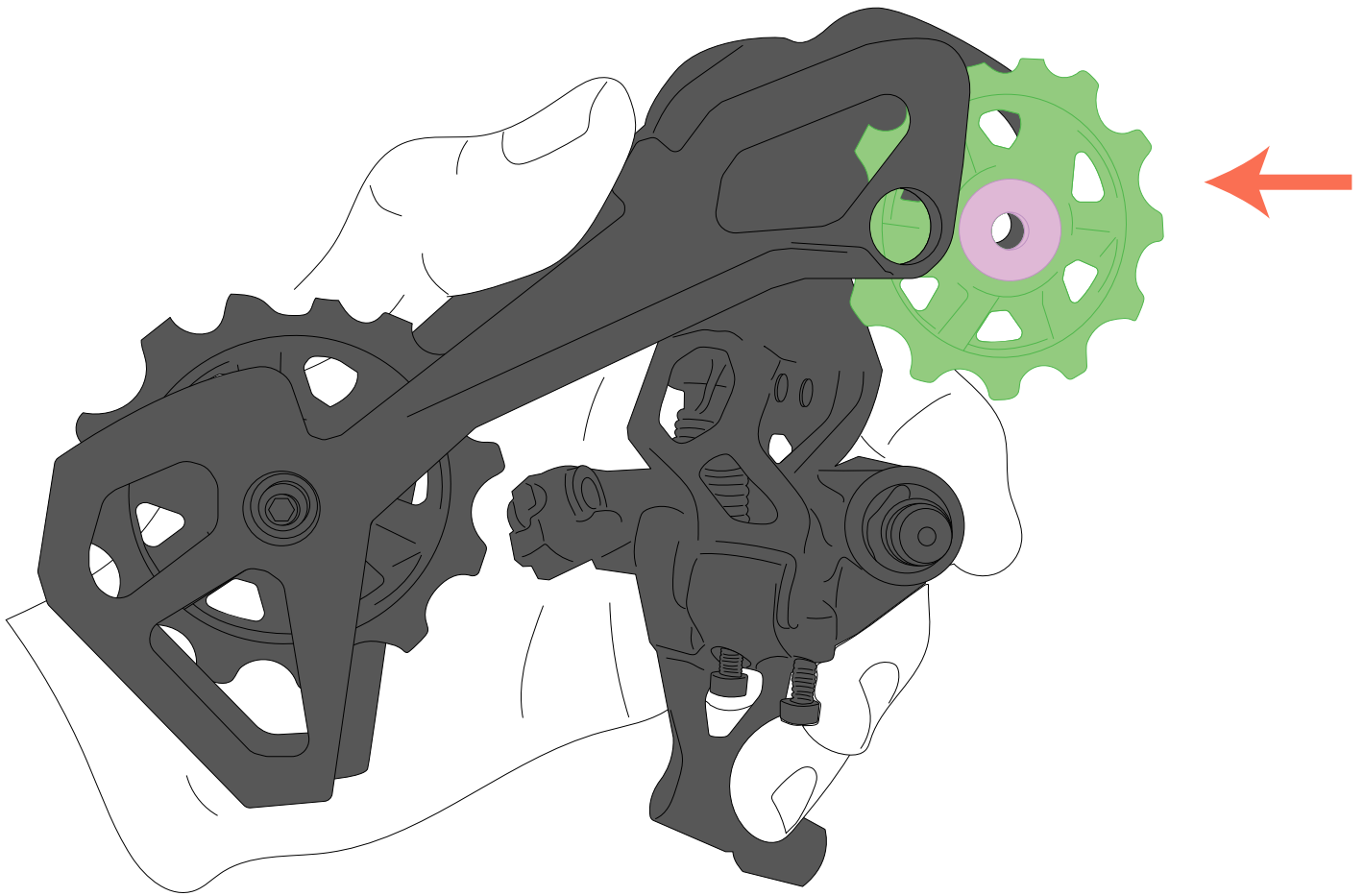

11.

Apply blue loctite to the **guide pulley mounting bolt** and thread it into place with a 3mm hex wrench. Torque to **2.5Nm**.

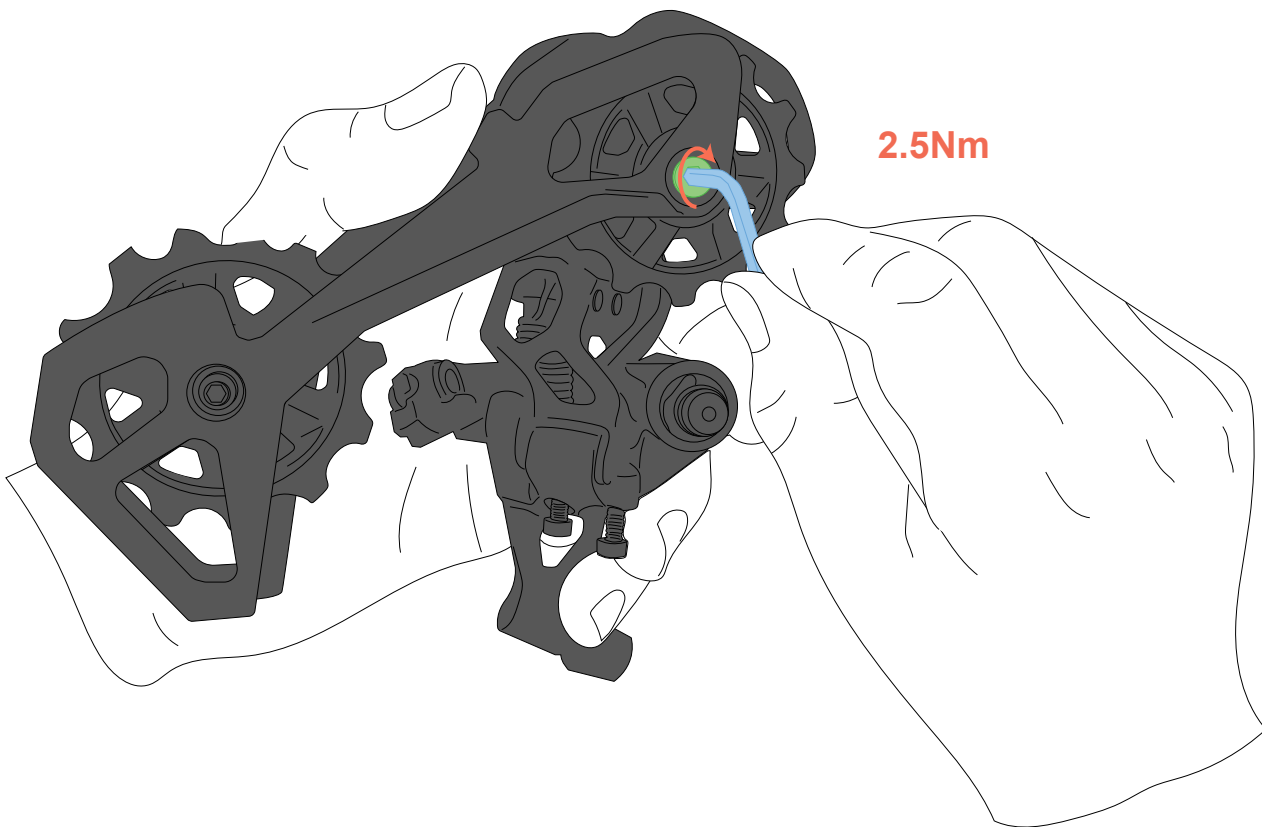

12.

Verify that the **tension pulley mounting bolt** is also torqued to **2.5Nm** using a 3mm hex wrench." add the 2.5Nm in red in the image.

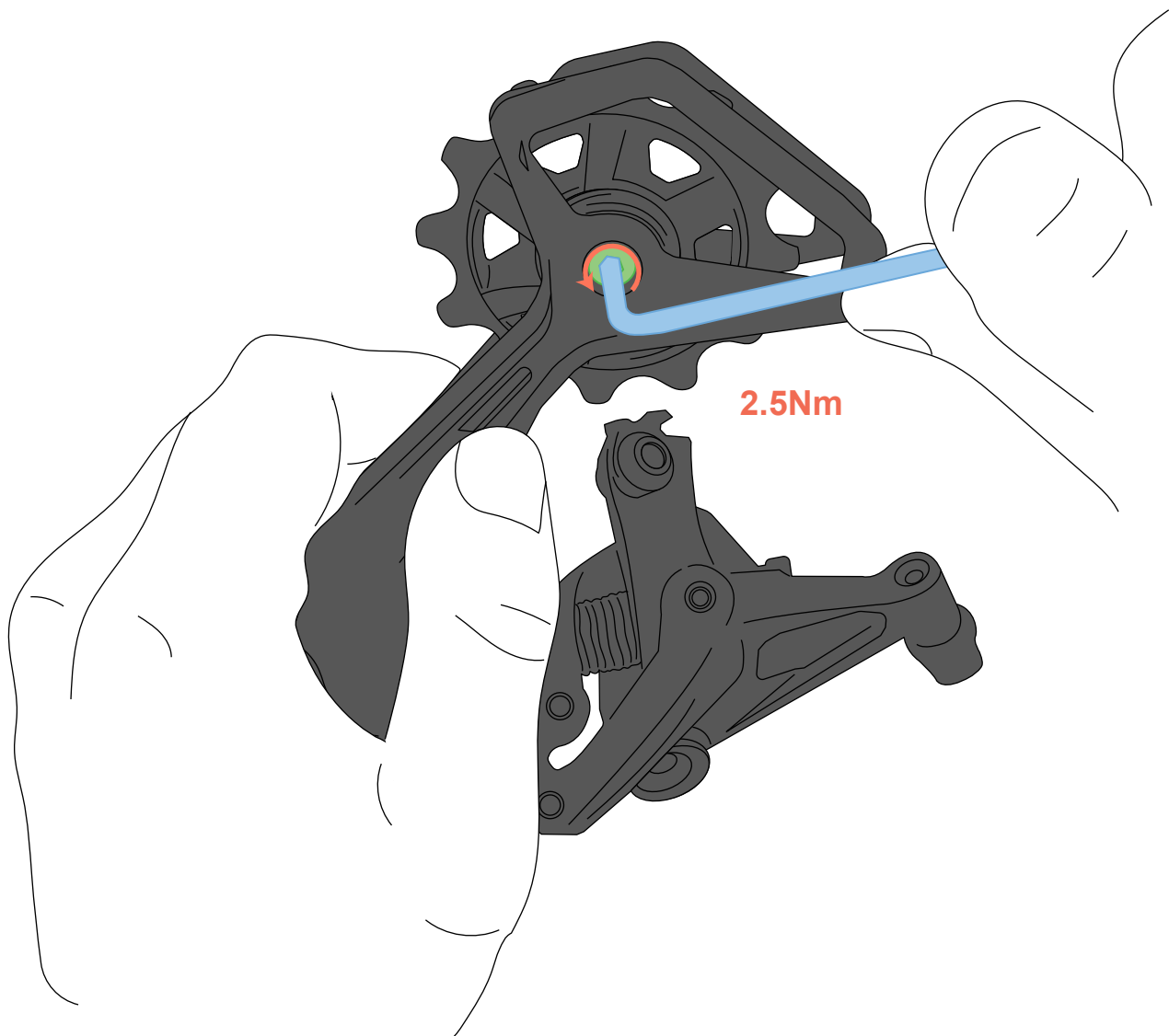

microSHIFT



www.microSHIFT.com